

GEOLOGY SPECIMEN CASE SPECIFICATIONS

MODEL GLX

Technical Data Sheet

| | |
|------------------------------|---|
| ◆ <i>Dimensions</i> | GLX Case Size: 58" Wide X 32" Deep X 78" High. If a different size is needed, please advise us the required measurements, so we can assist. |
| ◆ <i>Adaptability</i> | <p>Any of all of the following accessories can be installed in the GLX case easily and without tools. Vertical adjustments are in one inch (1") increments.</p> <ol style="list-style-type: none"> 1. Drawers*, full width - <ol style="list-style-type: none"> a. box, 1-3/4" high (2" spacing) b. box, 2-3/4" high (3" spacing) c. box, 3-3/4" high (4" spacing) d. roll storage rack, 3-3/4" high (4" spacing) e. roll storage rack, 5-3/4" high (6" spacing) 2. Drawers*, half width - <ol style="list-style-type: none"> a. box, 1-3/4" high (2" spacing) b. box, 2-3/4" high (3" spacing) c. box, 3-3/4" high (4" spacing) d. tray insert, 7/8" high, divides interior height of drawer into two levels to reduce stacking of delicate items and increase effective storage space. *1. All drawers have flush handles and label holders to increase effective storage volume and improve appearance. Sliding surfaces are enclosed so the drawer can be handled outside the case without soiling hands or work surfaces. *2. GLX system drawers are not interchangeable with the Model GL or GL-C Trays. *3. DRAWERS WITH SUSPENSION: Drawers can have full progressive extension suspension double steel ball bearing; leveler glide; welded back stops, positive lock out. They are interchangeable and can be easily removed. 3. Shelves - <ol style="list-style-type: none"> a. full width b. full width heavy duty c. full width with hanger rod d. half width e. half width with hanger rod 4. Center dividers (to support half width accessories) - <ol style="list-style-type: none"> a. 20" high with cover shelf b. 30" high with cover shelf c. 40" high with cover shelf d. 50" high with cover shelf e. full height |

| | |
|---|---|
| <p>♦ Doors</p> | <p>Doors are 1-3/8" thick, 18 gauge double panel construction. The entire closure system (including holes for shaft, latch channels, and hinge attachment) is outside the air-tight envelope. This feature, combined with the NPS gasket system, produced a case of unprecedented air-tightness, fumigant-tightness and bug-tightness. Any door hinge or latch adjustments that might be required to compensate for gasket wear over the years can be made with ordinary hand tools. A stainless steel panel on each door serves as a combination door handle escutcheon, label holder (for 5" x 8" cards), and fumigant status indicator. Filter vents are installed in each door and doors open a full 180 degrees.</p> |
| <p>♦ Filter Vents (optional)</p> | <p>Filter vents shall be installed on the inside face of each door to allow fresh air to circulate within the case. These vents shall be screened with mesh with a maximum opening of .015 mil. Vents shall be adaptable for filtering air through activated charcoal or Purafil as well as for complete closure.</p> |
| <p>♦ Gasket</p> | <p>The door opening is sealed with a continuous, air filled, silicone gasket that is held in place mechanically (no adhesives). This gasket system was developed for the National Park Service and is used on all Steel Fixture cases furnished to that agency. It is tops for long term, air-tight, dust-tight, light-tight protection combined with proven resistance to fumigants and commonly used chemicals. If damaged, the gasket can be replaced with ordinary hand tools.</p> |
| <p>♦ Structure</p> | <p>18 gauge case construction combined with a 14 gauge lapped and fusion welded door frame, corner post top; bottom is 14 gauge; top to be watertight; 2-1/2" high base with toe space.</p> |
| <p>♦ Hardware</p> | <p>All locks to be keyed the same. Each door is supported with a full length concealed piano hinge and closed tightly with beveled steel channels engaging latch plates at the head and sill. The channels are operated by flush, heavy duty, oversize handles. The handles are more durable and safer than "old style" handles because they do not project; their large size provides a more powerful closing action for gasket compression. The right hand door handle has a tang which engages the left hand door to compress the astragal gasket as well as having a keyed paracentric lock which effectively locks both doors. The flush handles will also conserve valuable space if the cases should ever be placed on mobile platforms for high-density compact storage.</p> |
| <p>♦ Options</p> | <ol style="list-style-type: none"> 1. The case size can be altered to meet your requirements. 2. Visual Windows can be added to the doors. 3. Fumigant valves can be installed in doors for placing liquid or gaseous fumigants inside the case without opening doors. 4. Filtered ventilation openings can be provided in the doors. 5. The recessed base for each case is removable. The base can be furnished in sections large enough for several cases, which greatly simplifies the installation of cases set in groups. 6. Drawers can be equipped with stops to prevent inadvertent removal (and dropping). 7. Drawers can be equipped with Ball Bearing Suspensions. 8. Doors can be provided with a stop and hold open device. 9. A fascia-curb and deck can be added on top of the cases for additional open storage. These cases are so strong that a usable mezzanine can be created. 10. Matching roll storage units can be furnished for rolls that are longer than the interior width of the standard GLX case. 11. A Caster Base for easier moving about. 12. A Sanitary Base to make cleaning easier. |
| <p>♦ Finish</p> | <p>All corners are rounded; exposed edges shall be deburred.</p> <p>All materials in the cases are power washed, phosphatized, sealed and rinsed. Surfaces are finished with non-reactive solvent-free powder coating which is electrostatically applied and baked to a hard finish.</p> <p>It has no off-gassing of formaldehyde and organic acid as compared to the solvent base paints.</p> <p>We feel this is the best metal preparation and finish that can be provided.</p> |
| <p>♦ Guarantee</p> | <p>Defects in design, materials or workmanship that occur within seven (7) years following the completion date shall be remedied by the manufacturer at no expense to the owner.</p> |

Model GLX

(Shown with standard base)

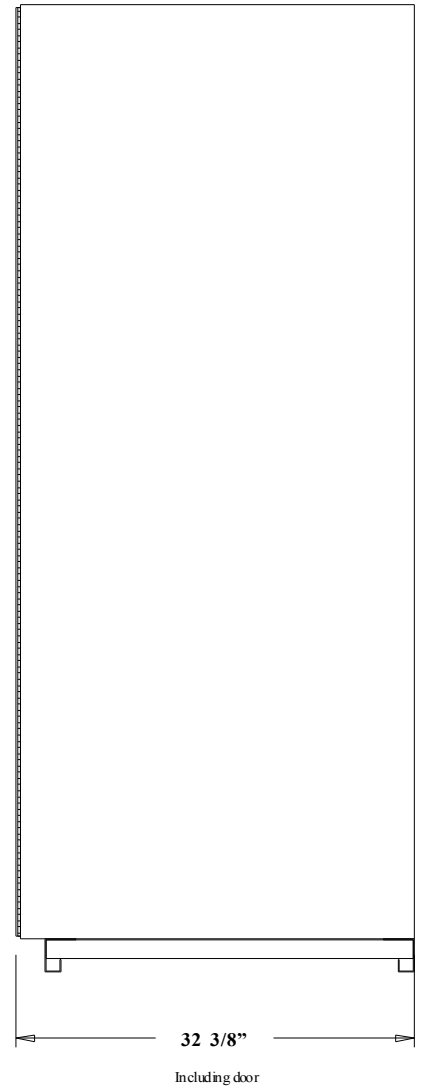
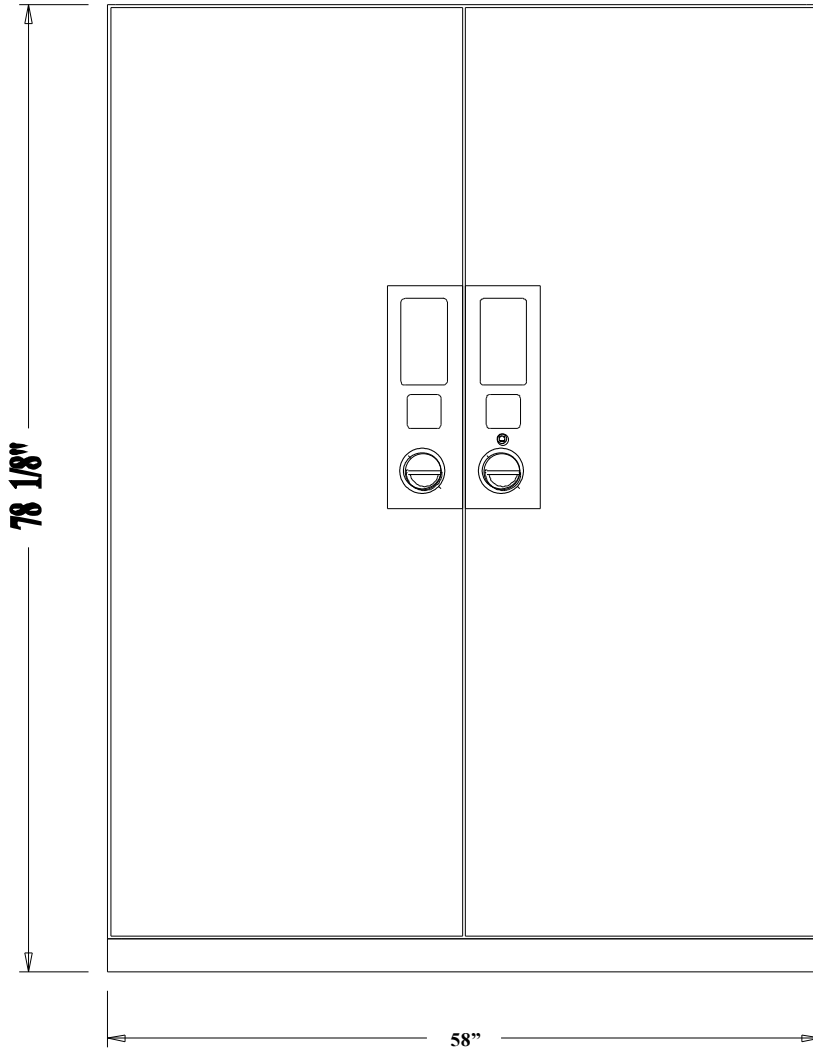

Steel Fixture's MUSEUM LINE Products



SINCE 1907

THE STEEL FIXTURE MANUFACTURING COMPANY

785-233-8911

612 S.E. 7th St.
Topeka, KS. 66607-1109

800-342-9180
sales@steelfixture.com

Fax: 785-233-8477
www.steelfixture.com